

079667

土地積測量所存在

地番	986-15	986-192 986-193 986-194 986-195 986-196	986-197 986-198 986-199 986-200 986-201	986-202 986-203 986-204
----	--------	---	---	-------------------------------

土地の所在 宇都宮市 五代1丁目

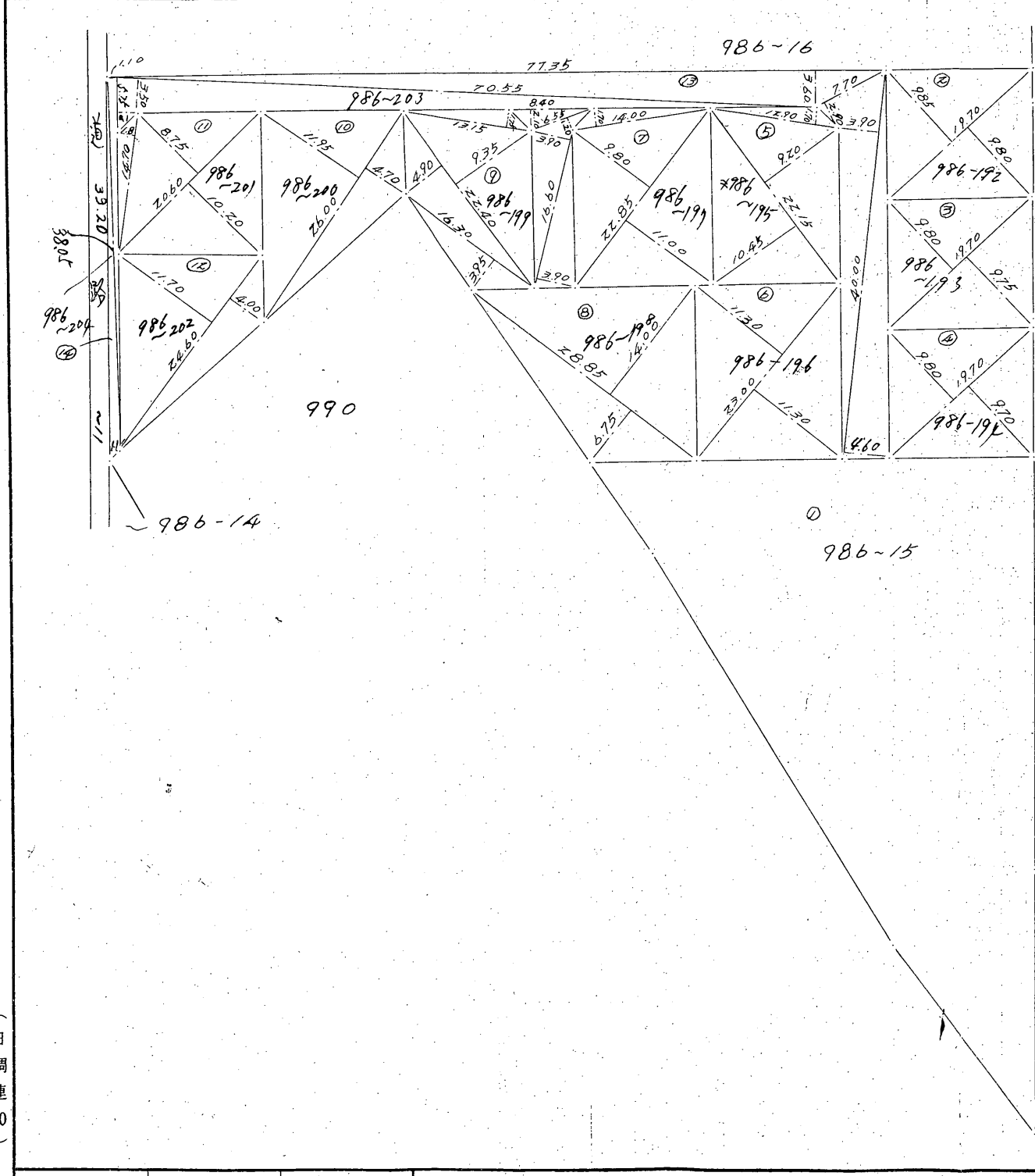

986-154	②	$19.70 \times (9.85 + 9.80) \frac{1}{2} = 193.5525 \text{ m}^2$
	③	$19.70 \times (9.80 + 9.75) \frac{1}{2} = 192.5675 \text{ m}^2$
	④	$19.70 \times (9.80 + 9.70) \frac{1}{2} = 192.075 \text{ m}^2$
	⑤	$12.90 \times 1.70 = 21.93$ $22.15 \times (9.20 + 10.45) \frac{1}{2} = 217.62375$ <u>228.58875 m²</u>
986-160	⑥	$23.00 \times (11.30 + 11.30) \frac{1}{2} = 259.9 \text{ m}^2$
	⑦	$14.00 \times 1.70 \frac{1}{2} = 11.9$ $22.85 \times (9.80 + 11.00) \frac{1}{2} = 237.64$ <u>249.54 m²</u>
986-170	⑧	$28.85 \times (14.00 + 6.75) \frac{1}{2} = 299.31875 \text{ m}^2$
	⑨	$13.15 \times 1.75 \frac{1}{2} = 11.50625$ $22.40 \times (9.35 + 4.90) \frac{1}{2} = 159.6$ $16.30 \times 3.95 \frac{1}{2} = 32.1925$ <u>203.29875 m²</u>
	⑩	$26.00 \times (11.95 + 4.70) \frac{1}{2} = 216.45 \text{ m}^2$
	⑪	$14.70 \times 1.80 \frac{1}{2} = 13.23$ $20.60 \times (8.75 + 10.20) \frac{1}{2} = 195.185$ <u>208.415 m²</u>
	⑫	$24.60 \times (11.70 + 4.00) \frac{1}{2} = 193.11 \text{ m}^2$
	⑬	$40.00 \times (3.90 + 4.60) \frac{1}{2} = 170.0$ $7.70 \times 2.90 \frac{1}{2} = 11.165$ $77.35 \times 3.60 \frac{1}{2} = 139.23$ $70.55 \times 3.50 \frac{1}{2} = 123.4625$ $8.40 \times 2.10 \frac{1}{2} = 8.82$ $6.55 \times 1.20 \frac{1}{2} = 3.93$ $16.60 \times (2.90 + 3.90) \frac{1}{2} = 64.74$ $5.75 \times 2.10 \frac{1}{2} = 6.0375$ <u>527.3850 m²</u>
	⑭	$38.05 \times 1.10 \frac{1}{2} = 20.9275$ $39.20 \times 1.10 \frac{1}{2} = 21.56$ <u>42.4875 m²</u>

昭和47年6月17日
作製者
宇都宮市新富町式番七号
土地家屋調査士
佐藤周文
申請人
山崎光彦

(日調連10)

縮尺	1/600	1/
----	-------	----

(日本土地家屋調査士会連合会用紙)

SH 47年6月1日登記